



Ventilation Solutions

HEAVY DUTY PROPELLER FANS | HIGH VOLUME LOW SPEED FANS | JET FANS | IN-LINE CENTRIFUGAL FANS
OSCILLATING FANS | CEILING CASSETTE EXHAUST FANS | CONTROLS AND ACCESSORIES

indola **EMI**

MaxAir

BROAN

ÖSTBERG



ABB



GEWISS

 **Zenith United**
ELECTRIC CORPORATION



Restaurants

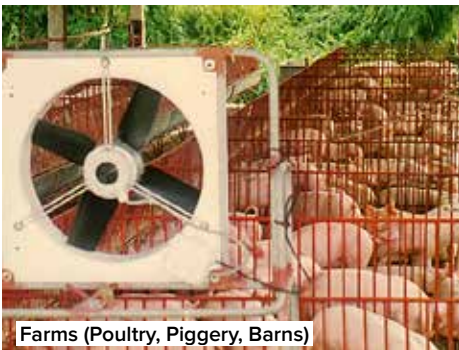

Farms (Poultry, Piggery, Barns)



Warehouses / Production Areas



Corrosive Areas



ADVANTAGES



Aerodynamic Design

- Maximum air volume & pressure with minimal electrical consumption
- Can be utilized as exhaust fan or blower/supply fan



0% corrosion

- Stainless Steel Propeller & Compound Polypropylene Casing (full anti-corrosion resistance)

- Can be installed in areas with critical condition such as: laboratories, areas with high chemical or high humid atmospheres
- Easy installation and mounting



Direct Drive Sealed Electric Motor

- (IP55) – 12” to 51” (Dust and Water Resistant)
- (IP44) – 8” to 10” (Dust and Splash Proof)



Insulation Class B & F

- Suitable for high ambient temperature operation (-20°C to 40°C)

- IP55 Wiring Box
- Energy Efficient
- Universal Mounting Installation
- Fully Enclosed Greased for life ball bearings
- Conforms to IEC/CEE Electrical Safety Standards



FEATURES

- Available range: 12 –36 inches
- Standard suitable for ambient temperatures up to 40 °C
- Water and dust resistant fan motor (IP55)
- Class ‘F’ insulation
- Low noise level

APPLICATIONS

Agricultural: Pigs, Poultry and Dairy,
Horticultural: Greenhouse, Industrial, Warehouse,
and Manufacturing or Sports Facilities

BASKET FAN

K4E5011I21100
20”(500mm) blade ø

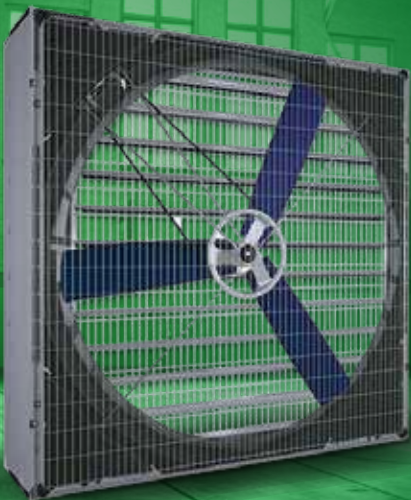

EMI 130 CASING FAN

CATALOG NO.	BLADE Ø (in.)	RPM	WATTS	AMP	VOLTS	IP RATING	AIR VOLUME	
							CMH	CFM
V4E1521	51”	570	1726	7.0	240	IP55	44115	25950
3 PHASE								
V4D1550	51”	570	1750	5.0/2.9	240/420	IP55	45305	26650

Motors: Insulation windings Class F
Ambient Temperature: -25°C and +40°C

Application: Gymnasiums, Warehouses, Factories

**HIGH
VOLUME LOW
SPEED FANS**

Revolutionary Fans with Energy Saving Performance

MaxAir



Controller*



CATALOG NUMBER	BLADE Ø	SOUND	POWER	WEIGHT	BLADE MAKE	RATED CURRENT (MAX)
IND73-3PH	24 ft. (7.3m)	50-55 dB	1.5 kw	120 kg	Aluminum Alloy	3.4A
IND61-3PH	20 ft. (6.1m)	50-55 dB	1.5 kw	105 kg	Aluminum Alloy	3.4A
IND42-1PH	14 ft. (4.2m)	< 43 dB	410 w	41 kg	Aluminum Alloy	2A

*Image may vary from actual item

MAXAIR SAFETY FEATURES:

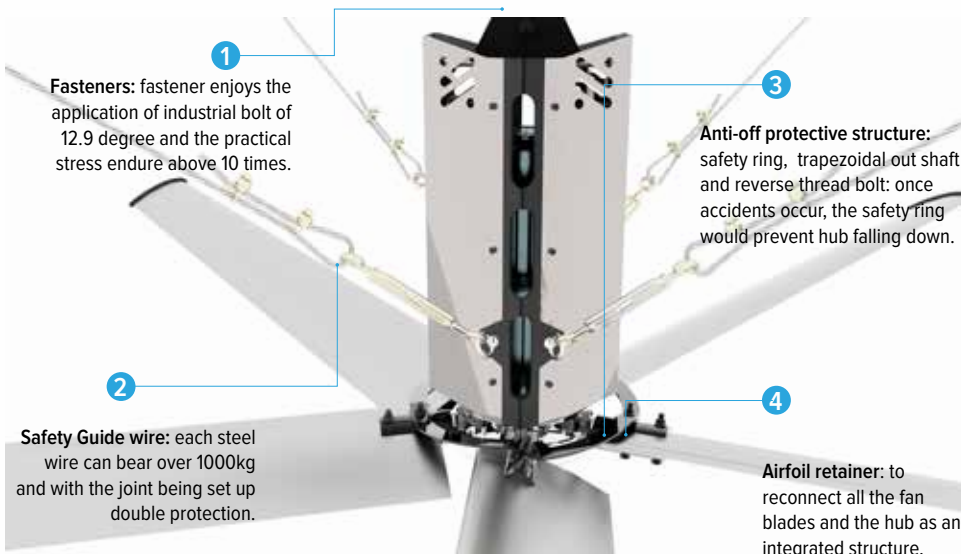

VFD control system: Once the fan blade hits a structure/ item, VFD Control Systems automatically alarm and stops the operation.

APPLICATIONS:

- Industrial buildings
- Factories / Logistics
- Workshops
- Concert Halls / Auditorium
- Warehouses
- Schools
- Gymnasiums
- Churches

BENEFITS:

- Comfort and Freshness
- Low Energy Cost
- Reduce risk and better working condition
- Improve air quality



JET FANS



CATALOG NO.	VOLTAGE	POWER	SPEED	NOISE	AIR VOLUME	PRESSURE	IMPELLER Ø
MA-250	220V 60Hz/ 1 ph	300W	3300RPM	67dB	2000CMH	210Pa.	250mm
MA-300	220V 60Hz/ 1 ph	400W	3300RPM	69dB	3000CMH	270Pa.	300mm

Housing and Frame: Mild steel, powder coated 1.2mm

Motor: IP44, F Class

Bracket: 480mm-700mm (adjustable)

ACCESSORIES



AIR VENT CAP

- Stainless steel 304
- 0.4, 0.45mm thickness
- 100-150mm
- Brushed Silver



ALUMINUM FLEXIBLE DUCT

- Aluminum Foil + Polyester
- Single Layer (4", 5", 6", 8" Dia)
- Multi Layer (5", 6", 8" Dia)



AIR DUCT STRAPPING

- Stainless steel 304
- Width 12.5mm
- 91-114mm - 200-230mm

EXHAUST FANS



- Novel in design
- Low in noise
- Fine in insulation, safe and durable in use
- Suitable for use in Factories, Commercial and Greenhouses

BLADE Ø (in.)	AIR FLOW	SPEED	POWER	VOLTAGE
9"	780CMH	1400RPM	50W	220V/60Hz
12"	1800CMH	1400RPM	130W	220V/60Hz
15"	3300CMH	1400RPM	220W	220V/60Hz
18"	5100CMH	1400RPM	380W	220V/60Hz
24"	8700CMH	960RPM	380W	220V/60Hz

OSCILLATING FANS

Blade Ø (in.)	24"
Power	150W
Voltage	220-240V
RPM	1400
CMH	11100

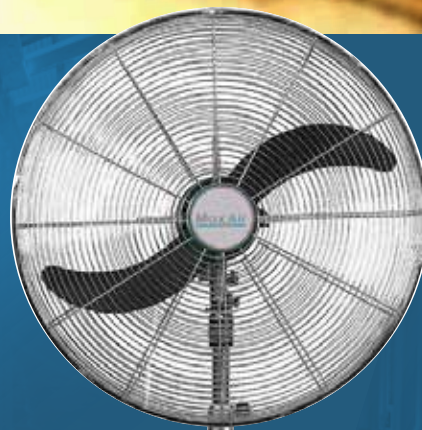

MA24-S



MA24-W

FEATURES

- Duct fan with rectangular connections.
- Proven performance and reliability.
- High capacity and very good efficiency.
- Impeller with backward curved blades.
- The external rotor motor has maintenance-free sealed ball-bearings and is very energy efficient.
- Speed controlling can be done with the built-in potentiometer, 0-10 V alt. external control.
- Integrated motor protection.
- Junction box has enclosure class IP 44.
- Fan housing is manufactured from galvanized sheet steel.
- Swing-out design to simplify maintenance and cleaning of the impeller.
- The fan is intended to be installed in a duct system.
- A duct connected fan can be installed outside or in damp environments.
- Easy installation in any position



MODEL	MAX STATIC PRESSURE	POWER	VOLTAGE	CURRENT	SPEED	SOUND PRESSURE LEVEL
RKB 500x250	1006 Pa	352W	200-277V 50/60HZ	2.67AMP, 1 PHASE	2830 RPM	@3M : 57 dB(A)
RKB 600x350 A1	532 Pa	360W	200-277V 50/60HZ	1AMP, 1 PHASE	1640 RPM	@3M : 56 dB(A)
RKB 700x400 B1	657 Pa	861W	200-277V 50/60HZ	3.8 AMP, 1 PHASE	1500 RPM	@3M : 61 dB(A)
RKB 800x500 A3	707 Pa	1240W	380-480V 50/60HZ	1.92AMP, 3 PHASE	1350 RPM	@3M: 60 dB(A)



- • Proven performance and reliability.
- • Compact with high capacity and efficiency.
- • Low sound levels.
- • Impeller with backward curved blades.

SERIES	CK 200 B	CK 250 C	CK 315 C
Catalog no.	1007000089	0.43A	2705
Max. Air Flow	1159 CMH	0.67A	2375
Max. Static Pressure	631Pa	0.85A	2790
Power	220W, 220-240V 60HZ	165W, 220-240V 60HZ	305W, 220-240V 60HZ
Current	1AMP, 1PHASE	0.71AMP, 1PHASE	1.4AMP, 1PHASE
Speed	2730RPM	2530RPM	2655RPM
Sound Pressure Level at 3M	47DB(A)	50DB(A)	50DB(A)
	Complete with Bracket	Complete with Bracket	Complete with Bracket



KINGLAN FANS

CATALOG NO.	BLADE Ø (in.)	RATED CURRENT	AIR VOLUME	
			CMH	CFM
FA-A013PH	4" duct Ø	0.10A	130	77
FA-A016PH	4" duct Ø	0.12A	160	94
FA-C020PH	4" duct Ø	0.18A	200	117



MELAN FANS

CATALOG NO.	BLADE Ø (in.)	RATED CURRENT	AIR VOLUME	
			CMH	CFM
FC-A040PH	6" duct Ø	0.23A	400	235



PREMIUM FANS

CATALOG NO.	BLADE Ø (in.)	RATED CURRENT	AIR VOLUME	
			CMH	CFM
FE-DO55B	6" duct Ø	0.27A	530	312
FE-EO80B	6" duct Ø	0.12A	441	312

SIROCCO FANS



CATALOG NO.	VOLTAGE FREQUENCY V/HZ	POWER (W)	SOUND (dB)	PRESSURE	
				CMH	(Pa.)
DE-BO33B	220/60Hz	37	37	300	130
DE-CO50B	220/60Hz	70	45	480	215

SUPER-ENERGY SAVING DUCT VENTILATORS



CATALOG NO.	VOLTAGE (V/Hz)	AIR VOLUME (M ³ /H)		POWER (W)		PRESSURE (Pa.)		SOUND (dB)	
		HI	LO	HI	LO	HI	LO	HI	LO
		DB-A016B	220/60	160	130	13	8	180	150
DB-B033B	220	330	280	24	16	170	120	25	22

SOLAR-POWERED ATTIC VENTILATOR



CATALOG NO.	VOLTAGE	POWER CONSUMPTION	MAX. AIR VOLUME (M ³ /H)	SOUND (dB)	INSTALLATION OPENING



DUCT-FREE
Ventilation Fan

Charcoal Filter processes air to eliminate odors where ductwork is impossible or impractical.

CATALOG NO.	VOLTAGE	FREQUENCY	POWER CONSUMPTION		AIR VOLUME (M ³ /H)		SOUND (dB)	
			Hi	Lo	Hi	Lo	Hi	Lo
			GA-A065	230	60	48	34	210



BROAN X8

Bidirectional Flow Cabinet Air Ventilation Recycling System

- Large air volume 400 – 800m³/h fresh air volume
- With fresh air, internal circulation, smart, sleep & MAX mode
- Low energy consumption
- Triple filters for efficient cleaning

APPLICATIONS

Hospital, School, Gym



BROAN

Under cabinet
RANGEHOOD

- Front Recirculation
- 3 Speeds Push Button
- Beautiful LED Strips
- 430#SS Finish
- AI. Filters
- 220V/60Hz



**BREAKERS, CONTACTORS,
OVERLOAD RELAYS & SOFT STARTERS**



Moulded Case
Circuit Breaker



Magnetic
Contactor



Miniature
Circuit Breaker



Manual Motor
Starter



Overload Relay



Soft Starter
PSE Series



DIRECT ON-LINE (DOL)



WYE - DELTA (Y-Δ)



ENCLOSED CIRCUIT BREAKER



CONTROLLER & THERMOSTATS



Mf-Net EW 3.15



Mf-Net T15-WD



Mf-Net T15-4



*Safety for any
application*

- 16 – 63A
- Surface mount

70 Rt
Rotary Isolator Switch

APPLICATIONS

Air conditioning systems, Lifts, Ventilation & Vacuum
Installations, Industrial Kitchens, industrial automation



COME AND VISIT OUR
SHOWROOM

HEAD OFFICE

2/F Le Mar Ben II Bldg.,
747 San Bernardo St., Sta. Cruz, Manila
T | +(632) 8733-8030 to 33
M | +(63) 925-519-9106 | 917-558-1151

RETAIL STORE

649 Florentino Torres St.,
Sta. Cruz, Manila
T | +(632) 8733-8026 to 29
M | +(63) 917-563-6152

CEBU OFFICE

11/F AppleOne-Equicom Tower
Mindanao Ave., Biliran Rd,
Cebu City, Philippines 6000
T | +(032) 317-0446
M | +(63) 917-558-1163
E | visayas@zenithunited.com

zenithunited
 mail@zenithunited.com
 www.zenithunited.com

YOUR FEEDBACK MATTERS.
For any customer concern
call us @ **0917-561-5961**